

VAN DYKE AVENUE

LEGEND

- UTILITY POLE
- SIGN
- CATCH BASIN
- MANHOLE
- LIGHT STANDARD
- DECIDUOUS TREE
- EVERGREEN TREE
- UNDERGROUND WATER LINE
- UNDERGROUND GAS LINE
- UNDERGROUND POWER LINE
- IRRIGATION BOX
- SPRINKLER HEAD
- FENCE
- OVERHEAD WIRES
- WATER GATE
- INDEX CONTOUR
- INTERMEDIATE CONTOUR
- SPOT ELEVATION
- SPOT ELEVATION AT TOP WALL
- SPOT ELEVATION AT BOTTOM OF WALL

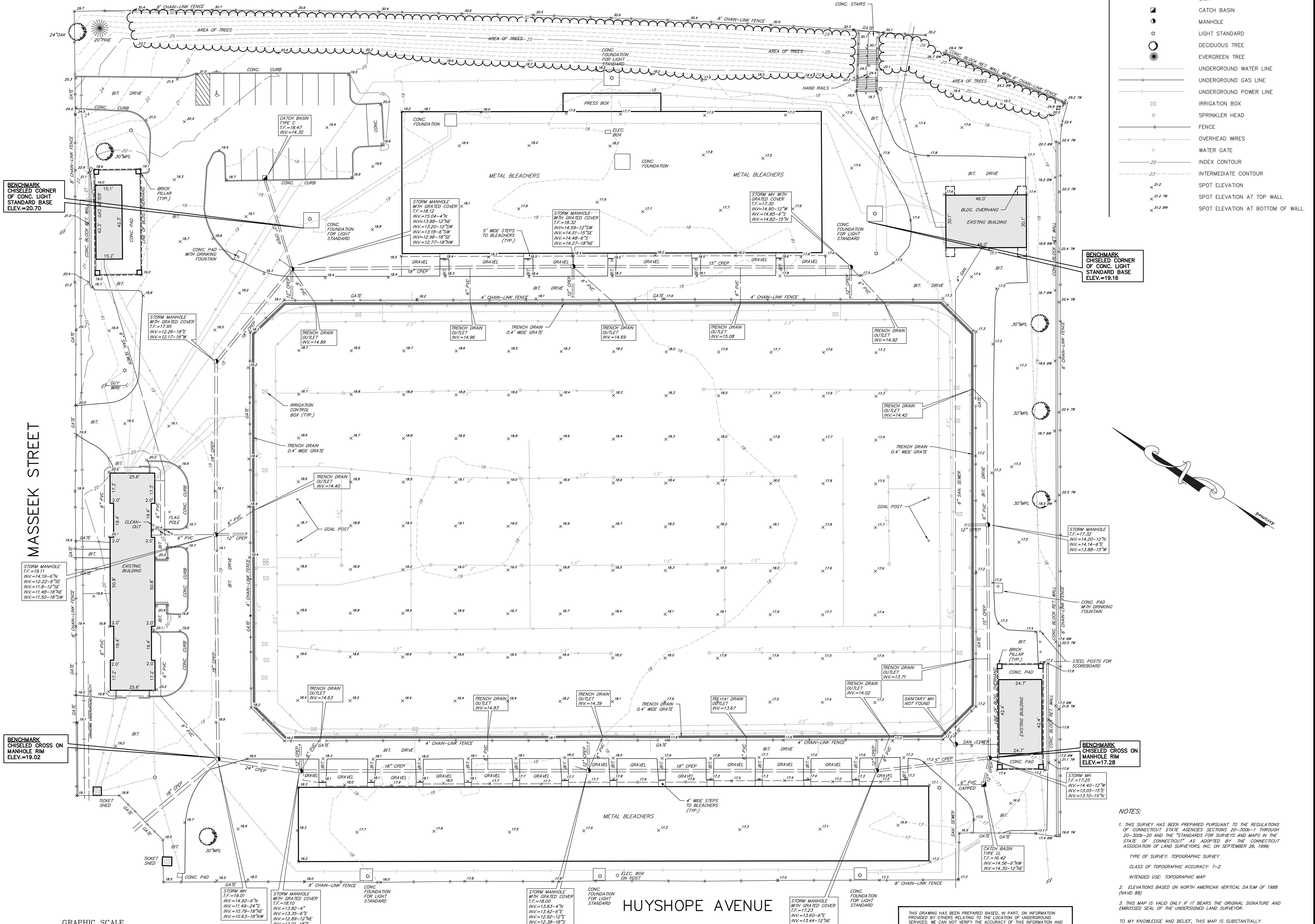

MASSEK STREET

HUYSHOPE AVENUE

BENCHMARK CHISELED CROSS ON MANHOLE RIM ELEV.=19.02

BENCHMARK CHISELED CORNER OF CONC. LIGHT STANDARD BASE ELEV.=19.16

BENCHMARK CHISELED CROSS ON MANHOLE RIM ELEV.=17.28

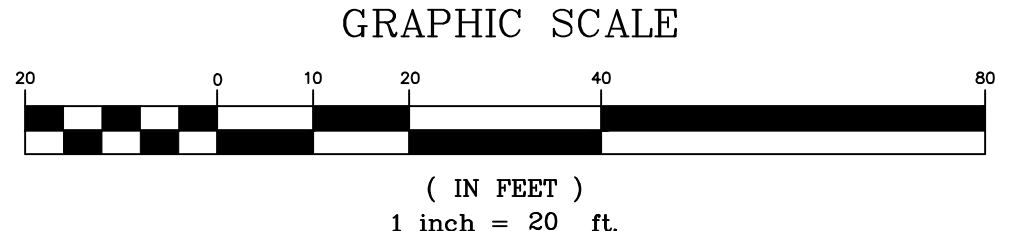

THIS DRAWING HAS BEEN PREPARED BASED, IN PART, ON INFORMATION PROVIDED BY OTHERS RELATING TO THE LOCATION OF UNDERGROUND SERVICES. WE CAN NOT VERIFY THE ACCURACY OF THIS INFORMATION AND SHALL NOT BE HELD RESPONSIBLE FOR ANY ERRORS OR OMISSIONS WHICH MAY BE INCORPORATED HEREIN AS A RESULT.

INDICATED UNDERGROUND UTILITIES ARE BASED ON AVAILABLE DATA. THE LOCATIONS ARE APPROXIMATE AND ALL UTILITIES MAY NOT BE SHOWN. CALL "CALL B-4-U DIO" AT 1-800-922-4455 PRIOR TO ANY EXCAVATION.

NOTES:

- THIS SURVEY HAS BEEN PREPARED PURSUANT TO THE REGULATIONS OF CONNECTICUT STATE AGENCIES SECTIONS 20-300b-1 THROUGH 20-300b-20 AND THE "STANDARDS FOR SURVEYS AND MAPS IN THE STATE OF CONNECTICUT" AS ADOPTED BY THE CONNECTICUT ASSOCIATION OF LAND SURVEYORS, INC. ON SEPTEMBER 26, 1996.
- ELEVATIONS BASED ON NORTH AMERICAN VERTICAL DATUM OF 1988 (NAVD 88).
- THIS MAP IS VALID ONLY IF IT BEARS THE ORIGINAL SIGNATURE AND EMBOSSED SEAL OF THE UNDERSIGNED LAND SURVEYOR.

TO MY KNOWLEDGE AND BELIEF, THIS MAP IS SUBSTANTIALLY CORRECT AS NOTED HEREON.

SURVEYOR'S SIGNATURE _____ DATE _____ LICENSE NUMBER 14649

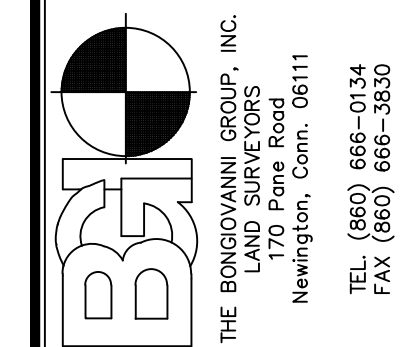

Date: 10-14-13	Scale: 1"=20'
Drawn: BIM	Checked: AB
Revision	Date

MAP OF
DILLON STADIUM
 HUYSHOPE AVENUE, MASSEK STREET AND
 VAN DYKE AVENUE
 HARTFORD, CONNECTICUT
 TOPOGRAPHIC SURVEY